

REVISIONS				
ZONE	REV	DESCRIPTION	Date	APPROVED

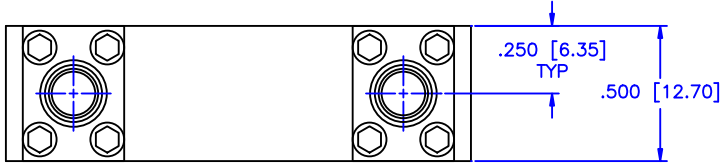

ELECTRICAL SPECIFICATIONS

Frequency Range: 23.0 to 25.0 GHz
 VSWR: 1.60:1 Max.
 Isolation Loss (Max): 17.0dB
 Insertion Loss (Max): 1.5dB
 Amplitude Unbalance: ±0.6dB
 Phase Unbalance: ±8° Max.

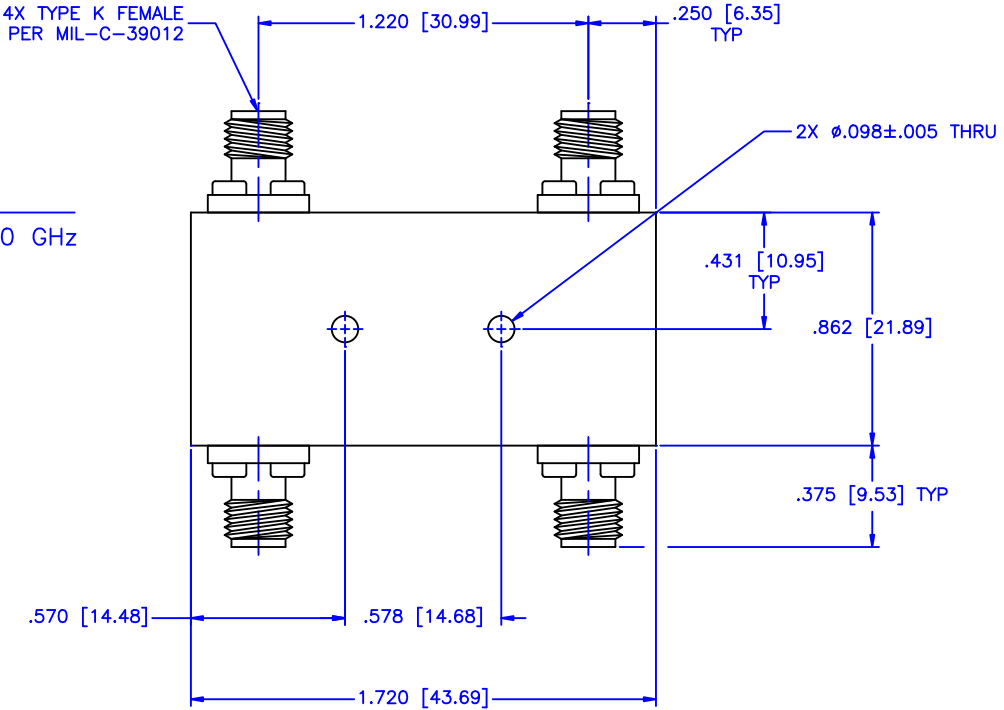

MATERIAL:		MCLI MICROWAVE COMMUNICATIONS LABORATORIES INC. 7255 30TH AVE. N. SAINT PETERSBURG, FL 33710 TEL: (727) 344-6254 FAX: (727) 381-6116 http://WWW.MCLI.COM	SCALE:	N/A
			SHEET:	N/A
DRAWN: Paiboon Luekhamhan		DATE: 04-13-2006	DRAWING TITLE: 90° HYBRID	
APPROVED: T. Nguyen		DATE: 04-13-2006	PART NO. HB-55	
PROPRIETARY NOTICE: THE INFORMATION IN THIS DRAWING IS PROPRIETARY AND SHALL NOT BE USED OR DISCLOSED WITHOUT WRITTEN PERMISSION FROM MICROWAVE COMMUNICATIONS LABORATORIES INC. (MCLI)		CAGE CODE: OD2L5	SIZE: N/A	REV: N/A
THIRD ANGLE PROJECTION 		DO NOT SCALE THE DRAWING		DWG NO. 83874